



User Guide

BlackBerry Power Station

Contents

Safety information	3
About the BlackBerry Power Station	5
Assemble the BlackBerry Power Station	7
Change the charging cradle	8
Using the BlackBerry Power Station at the office and at home	11
Charge your BlackBerry device	11
Charge an extra battery	11
Charge a battery with the BlackBerry C-Series Battery Charger	12
Charge an extra battery with the BlackBerry C-Series Battery Charger using a travel charger	12
Charge your BlackBerry device and an extra battery with the BlackBerry C-Series Battery Charger using your computer	13
Charge your BlackBerry device and a spare battery with the BlackBerry C-Series Battery Charger using a travel charger	13
Charge your BlackBerry HS-655 wireless headset	13
Using the BlackBerry C-Series Battery Charger on the road	15
Charge a spare battery with the BlackBerry C-Series Battery Charger using an automotive charger	15
Charge your BlackBerry device and an extra battery with the BlackBerry C-Series Battery Charger using an automotive charger	15
LED charging notification	17
Legal notice	19

Safety information

Please read these safety instructions and the operation instructions provided in this booklet before using the BlackBerry® Power Station. Retain these instructions for future use.

Electrical Safety

The BlackBerry Power Station is for indoor use only. Do not use the BlackBerry Power Station outside or in any area exposed to the elements. Do not use the BlackBerry Power Station in an area with an ambient temperature that is higher than 30 degrees Celsius or 85 degrees Fahrenheit.

You can only charge C-Series batteries with the BlackBerry Power Station. If your battery is a C-Series battery, the front label on your battery should display "C-" and the battery model number.

Do not place the BlackBerry Power Station or the BlackBerry device being charged on any unstable surface, such as a cart, stand, tripod, or bracket. It might fall, thereby potentially causing serious injury to a child or adult, and/or serious damage to the BlackBerry device. Take care when using the BlackBerry Power Station. Place the BlackBerry Power Station in a secure and stable spot and route all cables in a way that reduces the risk of injury to others, such as by tripping or choking.

The BlackBerry Power Station should be operated only from the type of power source indicated in the operation instructions. Route all cables so that they are not likely to be walked on, tripped over or pinched by items placed upon or against them. Pay particular attention to the BlackBerry Power Station at the point where it plugs in to the power outlet or convenience receptacles, the point where the power cable plugs in to the BlackBerry Power Station, and the point where the USB cable connects to the BlackBerry device. Do not overload power outlets, extension cords, or integral convenience receptacles as this can result in a risk of fire or electric shock. To reduce the risk of damage to the cord or the plug, pull by the plug rather than the cord when you disconnect the BlackBerry Power Station from the power outlet or convenience receptacle.

Never push objects of any kind into the BlackBerry device or BlackBerry Power Station through openings as they might short-out parts and could result in a fire or electric shock. Never spill liquid of any kind on the BlackBerry Power Station. Do not use the BlackBerry Power Station near water (for example near a bathtub, or a sink, in a wet basement, near a swimming pool, etc.). Whether in use or not, the BlackBerry Power Station should be situated away from heat sources, such as radiators, heat registers, stoves, flames, lit candles, cigarettes, or other products (including amplifiers) that produce heat.

Care

Unplug the BlackBerry Power Station from the power outlet before cleaning either the BlackBerry device or the BlackBerry Power Station. Do not use liquid or aerosol cleaners. Rather, use a dry cloth to clean the unit. Unplug the BlackBerry Power Station during lightning storms or when unused for long periods of time.

CAUTION: To reduce the risk of fire or electric shock, do not expose the BlackBerry Power Station to water, rain, or other moisture.

Service

Disconnect the USB cable from the BlackBerry device and unplug the BlackBerry Power Station from the power outlet and refer the BlackBerry device, BlackBerry Power Station, and any accessories for service to qualified service personnel if any of the following situations occur:

- The power cable or plug, USB cable or plug, any of the BlackBerry Power Station connectors, or the connector to the BlackBerry device is damaged.
- Liquid has been spilled on the BlackBerry Power Station.
- The BlackBerry Power Station has been exposed to rain or water.

- The BlackBerry Power Station becomes very hot to the touch.
- The BlackBerry Power Station has been dropped or damaged in any way.
- The BlackBerry Power Station does not operate normally, and you followed the instructions contained in this booklet.
- The BlackBerry Power Station exhibits a distinct change in performance.

Use the BlackBerry Power Station in accordance with the directions provided in this booklet. Improper use might result in damage and will potentially require extensive work by a qualified technician to restore the BlackBerry Power Station to its normal operation. Do not attempt to disassemble the BlackBerry Power Station.

For information on qualified service personnel in your area, please contact your wireless service provider or BlackBerry® reseller.

CAUTION: Failure to observe all these instructions will void the Limited Warranty, and might lead to suspension or denial of services to the offender, or legal action, or both.

About the BlackBerry Power Station

The BlackBerry® Power Station is a charging system that is designed to charge your BlackBerry device, your BlackBerry® HS-655 wireless headset, and a C-Series battery.

You might have purchased the BlackBerry Power Station as a separate accessory or as part of a larger accessory kit, which might include a BlackBerry® C-Series Battery Charger and a C-Series battery.

The BlackBerry Power Station is designed to charge a battery in the BlackBerry C-Series Battery Charger while the BlackBerry device charges in the charging cradle. The charging cradle is removable, and enables you to attach an alternate charging cradle to accommodate a different compatible BlackBerry device.

The BlackBerry Power Station is equipped with an integrated charging receptacle for a BlackBerry HS-655.

All of the connectors on the BlackBerry Power Station are designed to deliver power to BlackBerry accessories. The connectors do not provide a data connection. You can establish a data connection to a computer by connecting a USB cable from the computer to the mini-USB port on the BlackBerry device, or by using Bluetooth wireless technology.

Assemble the BlackBerry Power Station

1. Place the BlackBerry® Power Station base on a level surface, such as a table.
2. With one hand, hold the base of the BlackBerry Power Station.
3. With your other hand, grip the sides of the charging cradle.
4. Align the tabs on the back of the charging cradle with the slots on the base of the BlackBerry Power Station.

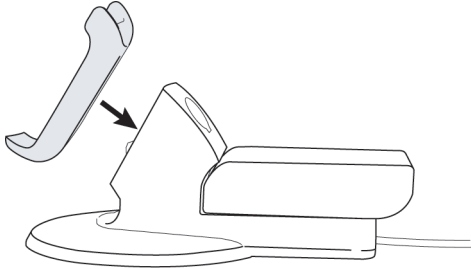

5. Slide the tabs downward in to the slots until the charging cradle is firmly in place.

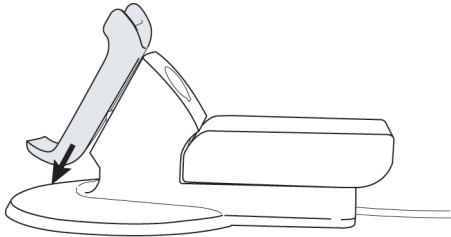

6. Align the slots and the USB port on the BlackBerry® C-Series Battery Charger with the tabs and the USB port on the base of the BlackBerry Power Station.

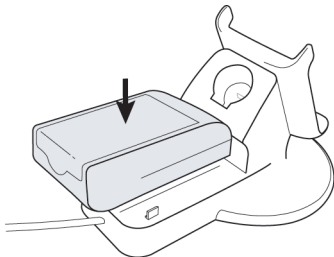

7. Slide the BlackBerry C-Series Battery Charger until it is firmly in place.

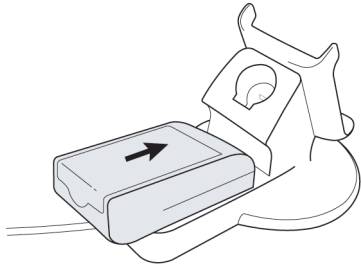

8. Depending on the type of power adapter that the BlackBerry Power Station is equipped with, slide the plug blade attachment into the power adapter or pull the plug blades down.
9. Plug the power adapter into a power outlet.

Change the charging cradle

You can change the charging cradle on the BlackBerry® Power Station to accommodate different compatible BlackBerry devices.

1. Disconnect the BlackBerry Power Station from the power outlet.
2. Remove your BlackBerry device from the BlackBerry Power Station charging cradle.
3. With one hand, hold the base of the BlackBerry Power Station.
4. With your other hand, grip the sides of the charging cradle and slide it upward to remove it from the base of the BlackBerry Power Station.

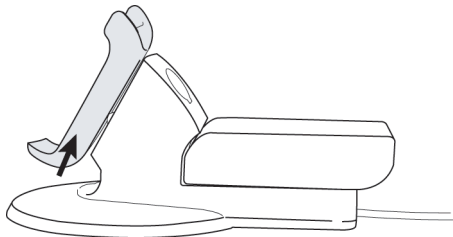

5. Align the tabs on the back of the alternate charging cradle with the slots on the base of the BlackBerry Power Station.

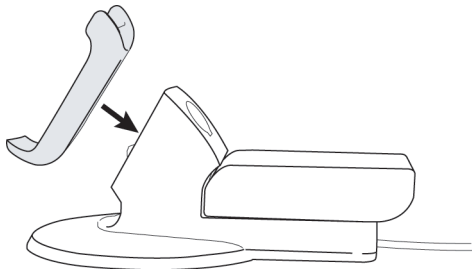

6. Slide the tabs downward in the slots until the charging cradle is firmly in place.

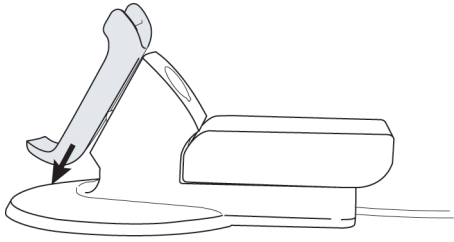

Using the BlackBerry Power Station at the office and at home

The BlackBerry® Power Station is designed to enable you to charge your BlackBerry device, a BlackBerry® HS-655 wireless headset and an extra C-series battery simultaneously. The BlackBerry Power Station enables you to choose the charging combination that you require. Once you have connected the power cable to a power outlet, place your device in the cradle to start the charging process.

Charge your BlackBerry device

Insert your BlackBerry device into the BlackBerry® Power Station so that the connectors on your device align with the connectors on the charging cradle.

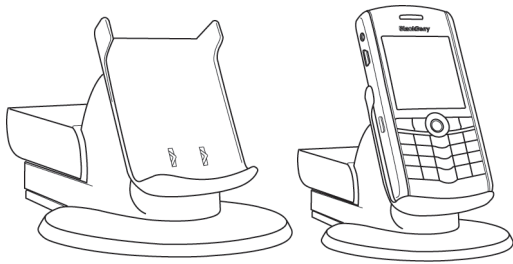

Charge an extra battery

Note: You can only charge C-Series Batteries with the BlackBerry® C-Series Battery Charger

1. While the BlackBerry C-Series Battery Charger is attached to the BlackBerry® Power Station, lift the front edge of the battery cover to open the BlackBerry C-Series Battery Charger.
2. Insert the battery so that the connectors on the battery align with the connectors on the BlackBerry C-Series Battery Charger.

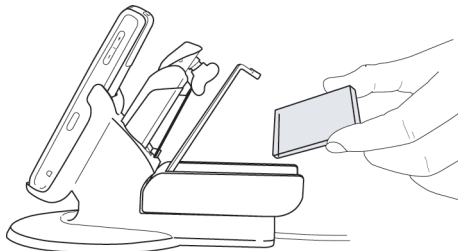

3. Close the battery cover.

Note: When the battery is charging, the LED light on the BlackBerry C-Series Battery Charger is amber.

Charge a battery with the BlackBerry C-Series Battery Charger

You can use the BlackBerry® C-Series Battery Charger when it is not attached to the BlackBerry® Power Station. The BlackBerry C-Series Battery Charger is designed to be compatible with BlackBerry charging accessories, including BlackBerry travel chargers and BlackBerry automotive chargers.

Note: You can only charge C-Series Batteries with the BlackBerry C-Series Battery Charger.

1. Slide the BlackBerry C-Series Battery Charger off of the stand to remove it from the BlackBerry Power Station.
2. Lift the front edge of the battery cover to open the BlackBerry C-Series Battery Charger.
3. Insert the battery so that the connectors on the battery align with the connectors in the BlackBerry C-Series Battery Charger.

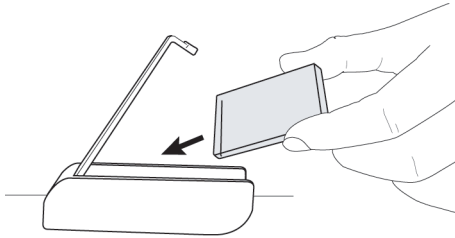

4. Close the battery cover.
5. Connect the smaller end of a USB cable to the BlackBerry C-Series Battery Charger.

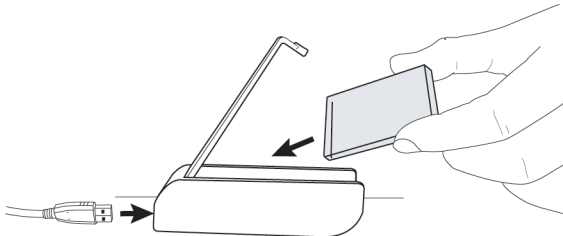

6. Connect the larger end of the USB cable to the USB port on your computer.

Charge an extra battery with the BlackBerry C-Series Battery Charger using a travel charger

You can use the BlackBerry® C-Series Battery Charger when it is not attached to the BlackBerry® Power Station.

Note: You can only charge C-Series Batteries with the BlackBerry C-Series Battery Charger.

1. Slide the BlackBerry C-Series Battery Charger off of the stand to remove it from the BlackBerry Power Station.
2. Lift the front edge of the battery cover to open the BlackBerry C-Series Battery Charger.
3. Insert the battery so that the connectors on the battery align with the connectors in the BlackBerry C-Series Battery Charger.
4. Close the battery cover.
5. Connect the smaller end of the USB cable to the BlackBerry C-Series Battery Charger.

6. Depending on the type of travel charger that you are using, slide the plug blade attachment into the power adapter or pull the plug blades down.
7. Plug the power adapter into a power outlet.

Charge your BlackBerry device and an extra battery with the BlackBerry C-Series Battery Charger using your computer

You can use the BlackBerry® C-Series Battery Charger when it is not attached to the BlackBerry® Power Station.

Note: You can only charge C-Series Batteries with the BlackBerry C-Series Battery Charger.

Note: Some computers may not be able to provide sufficient current for charging multiple devices efficiently.

1. Slide the BlackBerry C-Series Battery Charger off of the stand to remove it from the BlackBerry Power Station.
2. Connect the smaller end of the first USB cable to your BlackBerry device.
3. Connect the larger end of the first USB cable to the large USB port on the BlackBerry C-Series Battery Charger.
4. Lift the front edge of the battery cover to open the BlackBerry C-Series Battery Charger.
5. Insert the battery so that the connectors on the battery align with the connectors in the BlackBerry C-Series Battery Charger.
6. Close the battery cover.
7. Connect the smaller end of the second USB cable to the small USB port on the BlackBerry C-Series Battery Charger.
8. Connect the larger end of the second USB cable to your computer.

Charge your BlackBerry device and a spare battery with the BlackBerry C-Series Battery Charger using a travel charger

You can use the BlackBerry® C-Series Battery Charger when it is not attached to the BlackBerry® Power Station.

Note: Only C-Series Batteries can be charged using the BlackBerry C-Series Battery Charger.

1. Slide the BlackBerry C-Series Battery Charger off of the stand to remove it from the BlackBerry Power Station.
2. Connect the smaller end of the first USB cable to your BlackBerry device.
3. Connect the larger end of the first USB cable to the large USB port on the BlackBerry C-Series Battery Charger.
4. Lift the front edge of the battery cover to open the BlackBerry C-Series Battery Charger.
5. Insert the battery so that the connectors on the battery align with the connectors in the BlackBerry C-Series Battery Charger.
6. Close the battery cover.
7. Connect the smaller end of the second USB cable to the small USB port on the BlackBerry C-Series Battery Charger.
8. Depending on the type of travel charger that you are using, slide the plug blade attachment into the power adapter or pull the plug blades down.
9. Plug the power adapter into a power outlet.

Charge your BlackBerry HS-655 wireless headset

Note: The only headset that the BlackBerry® Power Station is compatible with is the BlackBerry® HS-655 wireless headset.

1. Place the BlackBerry HS-655 in its charging pocket.
2. Place the charging pocket in the integrated charging receptacle in the BlackBerry Power Station.

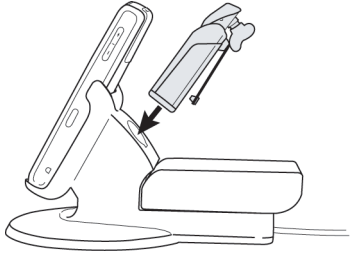

Using the BlackBerry C-Series Battery Charger on the road

The BlackBerry® C-Series Battery Charger is designed to charge a battery and your BlackBerry device simultaneously. You can connect the BlackBerry C-Series Battery Charger to a power source using a USB cable, a travel charger, or an automotive charger.

Since the BlackBerry C-Series Battery Charger is compact, you can carry it with you wherever you travel.

Charge a spare battery with the BlackBerry C-Series Battery Charger using an automotive charger

You can use the BlackBerry® C-Series Battery Charger when it is not attached to the BlackBerry® Power Station.

Note: You can only charge C-Series Batteries with the BlackBerry C-Series Battery Charger.

1. Slide the BlackBerry C-Series Battery Charger off of the stand to remove it from the BlackBerry Power Station.
2. Lift the front edge of the cover to open the BlackBerry C-Series Battery Charger.
3. Insert the battery so that the connectors on the battery align with the connectors in the BlackBerry C-Series Battery Charger.
4. Close the battery cover.
5. Connect the smaller end of the automotive charger to the small USB port on the BlackBerry C-Series Battery Charger.
6. Connect the larger end of the automotive charger to the convenience receptacle in your vehicle.

Charge your BlackBerry device and an extra battery with the BlackBerry C-Series Battery Charger using an automotive charger

You can use the BlackBerry® C-Series Battery Charger when it is not attached to the BlackBerry® Power Station.

Note: You can only charge C-Series Batteries with the BlackBerry C-Series Battery Charger.

1. Slide the BlackBerry C-Series Battery Charger off of the stand to remove it from the BlackBerry® Power Station.
2. Connect the smaller end of the USB cable to your BlackBerry device.
3. Connect the larger end of the USB cable to the large USB port on the BlackBerry C-Series Battery Charger.
4. Lift the front edge of the battery cover to open the BlackBerry C-Series Battery Charger.
5. Insert the battery so that the connectors on the battery align with the connectors in the BlackBerry C-Series Battery Charger.
6. Close the battery cover.
7. Connect the smaller end of the automotive charger to the small USB port on the BlackBerry C-Series Battery Charger.
8. Connect the larger end of the automotive charger to the convenience receptacle in your vehicle.

LED charging notification

The LED light appears on the BlackBerry® C-Series Battery Charger in amber, green, or red, depending on the status of the battery or BlackBerry device being charged.

LED color	Description
off	<ul style="list-style-type: none">No battery is inserted for charging.
amber	<ul style="list-style-type: none">A battery is inserted and charging.
green	<ul style="list-style-type: none">A battery is inserted and charged.
flashing red	<ul style="list-style-type: none">The BlackBerry C-Series Battery Charger is operating above normal operating temperature. The battery is not charging.
solid red	<ul style="list-style-type: none">The BlackBerry C-Series Battery Charger does not recognize the battery. You can only charge C-Series batteries with the BlackBerry C-Series Battery Charger. If your battery is a C-Series battery, the front label on your battery should display "C-" and the battery model number.

Legal notice

©2006 Research In Motion Limited. All Rights Reserved. The BlackBerry and RIM families of related marks, images, and symbols are the exclusive properties of Research In Motion Limited. RIM, Research In Motion, BlackBerry, "Always On, Always Connected" and the "envelope in motion" symbol are registered with the U.S. Patent and Trademark Office and may be pending or registered in other countries.

The Bluetooth word mark and logos are owned by the Bluetooth SIG, Inc. and any use of such marks by Research In Motion is under license. All other brands, product names, company names, trademarks, and service marks are the properties of their respective owners.

The BlackBerry device and/or associated software are protected by copyright, international treaties, and various patents, including one or more of the following U.S. patents: 6,278,442; 6,271,605; 6,219,694; 6,075,470; 6,073,318; D445,428; D433,460; D416,256. Other patents are registered or pending in various countries around the world. Visit www.rim.com/patents for a list of RIM (as hereinafter defined) patents.

This document is provided "as is" and Research In Motion Limited and its affiliated companies ("RIM") assume no responsibility for any typographical, technical, or other inaccuracies in this document. In order to protect RIM proprietary and confidential information and/or trade secrets, this document may describe some aspects of RIM technology in generalized terms. RIM reserves the right to periodically change information that is contained in this document; however, RIM makes no commitment to provide any such changes, updates, enhancements, or other additions to this document to you in a timely manner or at all. RIM MAKES NO REPRESENTATIONS, WARRANTIES, CONDITIONS, OR COVENANTS, EITHER EXPRESS OR IMPLIED (INCLUDING WITHOUT LIMITATION, ANY EXPRESS OR IMPLIED WARRANTIES OR CONDITIONS OF FITNESS FOR A PARTICULAR PURPOSE, NON-INFRINGEMENT, MERCHANTABILITY, DURABILITY, TITLE, OR RELATED TO THE PERFORMANCE OR NON-PERFORMANCE OF ANY SOFTWARE REFERENCED HEREIN OR PERFORMANCE OF ANY SERVICES REFERENCED HEREIN). IN CONNECTION WITH YOUR USE OF THIS DOCUMENTATION, NEITHER RIM NOR ITS RESPECTIVE DIRECTORS, OFFICERS, EMPLOYEES, OR CONSULTANTS SHALL BE LIABLE TO YOU FOR ANY DAMAGES WHATSOEVER BE THEY DIRECT, ECONOMIC, COMMERCIAL, SPECIAL, CONSEQUENTIAL, INCIDENTAL, EXEMPLARY, OR INDIRECT DAMAGES, EVEN IF RIM HAS BEEN ADVISED OF THE POSSIBILITY OF SUCH DAMAGES, INCLUDING WITHOUT LIMITATION, LOSS OF BUSINESS REVENUE OR EARNINGS, LOST DATA, DAMAGES CAUSED BY DELAYS, LOST PROFITS, OR A FAILURE TO REALIZE EXPECTED SAVINGS.

This document might contain references to third-party sources of information, hardware or software, products or services and/or third-party web sites (collectively the "Third-Party Information"). RIM does not control, and is not responsible for, any Third-Party Information, including, without limitation the content, accuracy, copyright compliance, compatibility, performance, trustworthiness, legality, decency, links, or any other aspect of Third-Party Information. The inclusion of Third-Party Information in this document does not imply endorsement by RIM of the Third-Party Information or the third party in any way. Installation and use of Third-Party Information with RIM's products and services may require one or more patent, trademark, or copyright licenses in order to avoid infringement of the intellectual property rights of others. Any dealings with Third-Party Information, including, without limitation, compliance with applicable licenses and terms and conditions, are solely between you and the third party. You are solely responsible for determining whether such third-party licenses are required and are responsible for acquiring any such licenses relating to Third-Party Information. To the extent that such intellectual property licenses may be required, RIM expressly recommends that you do not install or use Third-Party Information until all such applicable licenses have been acquired by you or on your behalf. Your use of Third-Party Information shall be governed by and subject to you agreeing to the terms of the Third-Party Information licenses. Any Third-Party Information that is provided with RIM's products and services is provided "as is". RIM makes no representation, warranty or guarantee whatsoever in relation to the Third-Party Information and RIM assumes no liability whatsoever in relation to the Third-Party Information even if RIM has been advised of the possibility of such damages or can anticipate such damages.

Research In Motion Limited

295 Phillip Street

Waterloo, ON N2L 3W8

Canada

Research In Motion UK Limited

Centrum House, 36 Station Road

Egham, Surrey TW20 9LF

United Kingdom

Published in Canada.